

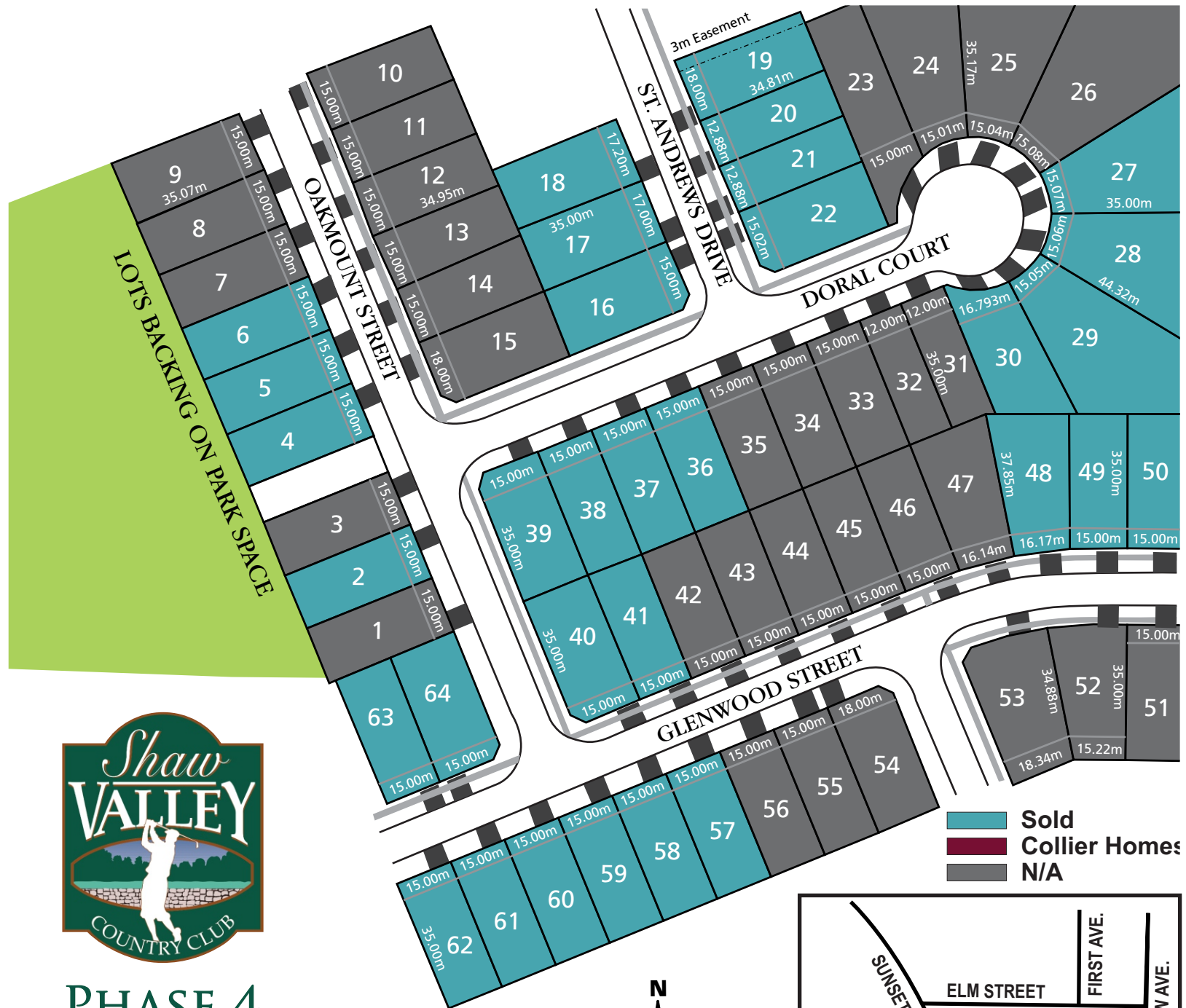

**Quality Homes
At Affordable Prices**

42372 John Wise Line,
St. Thomas, ON N5R 5T5
519-633-9642
rickcollier@rogers.com
www.collierhomes.ca



Lots for Sale - Phase 4

Lot #	Frontage (m)	Sale Price
2	15r	Sold \$93,500
4	15r	Sold \$93,500
5	15r	Sold \$93,500
6	15r	Sold \$93,500
16	15r	Sold \$74,500
17	17r	Sold \$84,500
18	17.2r	Sold \$85,500
19	18r	Sold \$81,700
20	12.8r	Sold \$65,800
21	12.8r	Sold \$65,800
22	15r	Sold \$76,600
27	15r	Sold \$89,800
28	15r	Sold \$89,800
29	15r	Sold \$93,800
30	15r	Sold \$89,800
36	15r	Sold \$77,700
37	15r	Sold \$77,700
38	15r	Sold \$77,700
39	18r	Sold \$77,700
40	18r	Sold \$72,400
41	15r	Sold \$72,400
48	16.1r	Sold \$77,800
49	15r	Sold \$72,400
50	15r	Sold \$72,400
57	15r	Sold \$72,400
58	15r	Sold \$72,400
59	15r	Sold \$72,400
60	15r	Sold \$72,400
61	15r	Sold \$72,400
62	15r	Sold \$72,400
63	15r	Sold \$72,400
64	15r	Sold \$72,400



PHASE 4

Building permits
available fall 2016.
Now taking deposits
on lots.

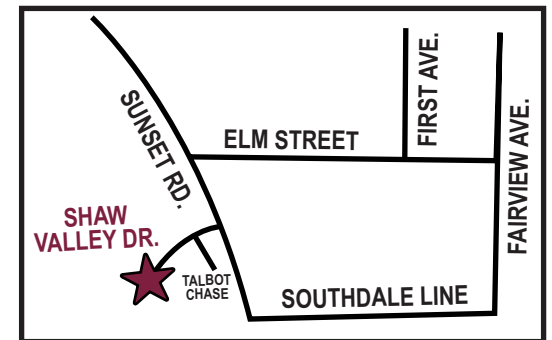
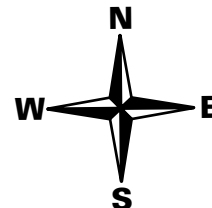

SPECIFICATION SHEET SCHEDULE B

EXTERIOR FEATURES

- Building permit and levies included.
- Sanitary sewers, water and gas, underground hydro, telephone, cable TV.
- Paved street with curb, gutter, sidewalk and street lights as per subdivision plan.
- Entire lot to be graded and fully sodded
- Concrete foundation, basement and garage floors. Clay brick per selection from suppliers' samples.
- All exterior doors are steel insulated.
- 2 Exterior water tap.
- 2 Waterproof exterior electric outlet.
- All exterior windows double glass.
- Screens on all operating windows, grills and shutters as shown on model.
- Insulating glass patio doors complete with screens, where applicable.
- Limited lifetime asphalt roof shingles.
- Pre-finished maintenance free aluminum/vinyl seamless eavestrough, soffits, & fascia.
- Poured concrete porch and patio stones to driveway.
- Paved driveway

INTERIOR FEATURES

- 3 Cable & 3 Telephone outlets.
- Electrical outlets as per Ontario Hydro specs.
- All subfloors 5/8" tongue and groove plywood, nailed and screwed.
- All light fixtures and door chimes supplied and installed by Vendor.
- Choice of high quality broadloom and cushion vinyl as per builder's samples.
- Colonial painted trim and series 800 doors
- Interior walls of living area and garage to be drywall.
- One-half inch gypsum board fastened by screws on walls.
- 1/2" gypsum board fastened by screws on all insulated ceilings.
- All walls painted two coats, three colours throughout.
- Textured and flat ceilings.

HEATING SYSTEM

- High-efficient forced-air natural gas furnace, sized for each home.
- Insulation to approved standards,
- R-50 attic, R-24 walls
- Duct work equipped to handle future air-conditioning

KITCHEN

- High quality custom-built kitchen cupboards with a selection of styles and finishes, with roll top counters.
- Two speed range hood.
- Double stainless steel sink.

BATHROOMS

- White/bone fixtures in all bathrooms.
- Custom built vanities with arborite roll-tops.
- Quality washerless faucets.
- Fiberglass tub enclosures.
- Power exhaust fans where applicable.
- Mirrors above vanities.

GARAGES

- Poured concrete floors.
- Painted steel sectional doors.
- Interior walls, drywalled & painted.
- Electrical outlet, overhead light.
- Walls painted standard colour.

MISCELLANEOUS

- 100-amp electric service with breaker panel-copper wiring.
- Heavy duty receptacle for clothes dryer and stove.
- Standard plastic laundry tub in basement
- Rental gas or electric hot water heater
- Water meter installed by PUC and gas meter installed by Union Gas.
- Location as per utility policy.
- Rough-in for 3 pc washroom in basement.
- Basements studded, with R20 insulation.